



AUSTRAL  
LOCK

# Yarra Ridge Deadlock Vent Lock Fitting instructions

These instructions describe the additional steps required to install a YR4000 Deadlock with Vent Lock to a Crane Mk5 Sliding Door. Refer to the standard fitting instructions for information on installing keyed cylinders (if required) and the fitting and adjustment of the Catch Assembly.

Read through all instruction steps before beginning installation.

## STEP 1

Prepare the D9653 Head to accept the Top Strike as per Figure A. Attach the Top Strike with 6G x 10 CSK screws.

## STEP 2

Prepare the D9965 Sill to accept the Sill Strikes as per Figure B. Attach the Sill Strikes with 6G x 20 CSK screws. Seal the screws with a small amount of silicone to ensure that the sill remains watertight.

## STEP 3

Prepare the D6832 Lock Stile to accept the lock as per Figure C.

## STEP 4

Assemble the Vent Lock, Bolts & Drive Rods. Ensure that the bolts are assembled in the same configuration as shown in Figure D.

For non-standard door heights, the cutting formula for the Drive Rods is shown in Figure E.

## STEP 5

Assemble the Stiles and Rails onto the Glass. Do not screw the lock stiles to the rails at this stage.

Feed the Vent Lock and Rod assembly into the Lock Stile. Feed the Guide Blocks into the lock stile and attach with the panel screws as per Figure F.

## STEP 6

Attach the Lock to the Lock Stile, passing the Lock Spindle through the vent lock Spindle Gear as per Figure F.

For the Crane Mk 5 Sliding Door, break off 3 portions of the Spindle and use the 1" Fixing Screws.

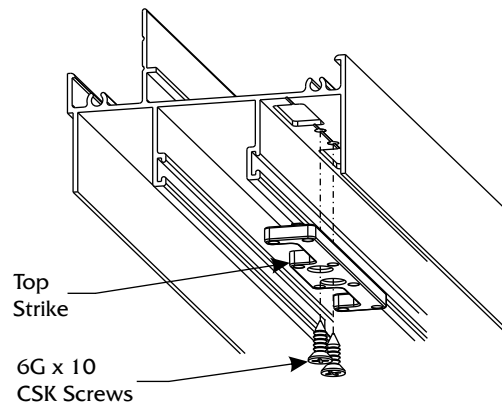
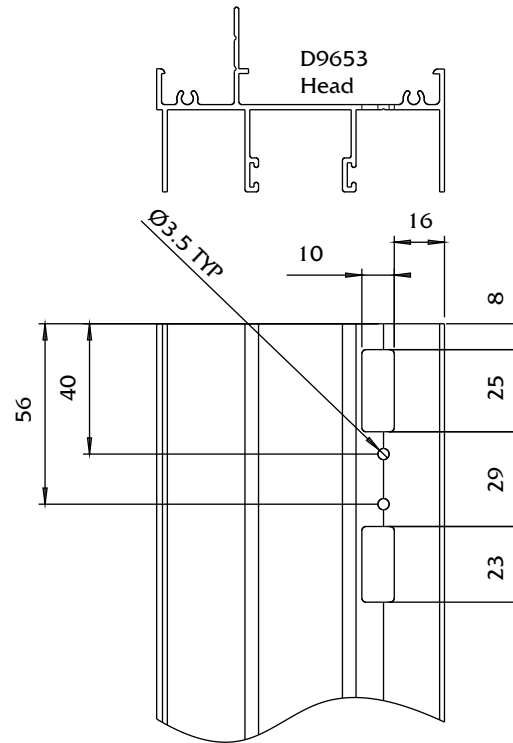

Figure A

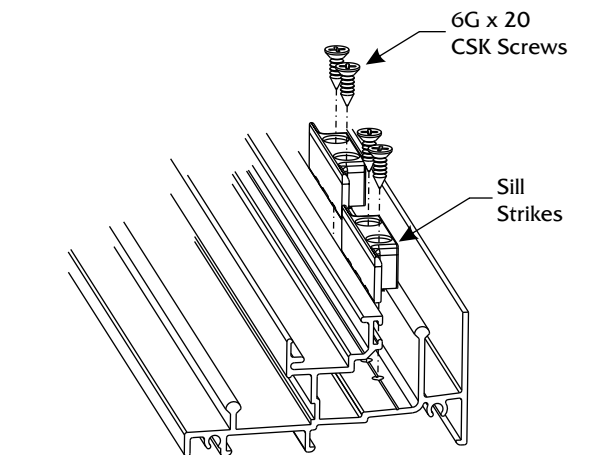
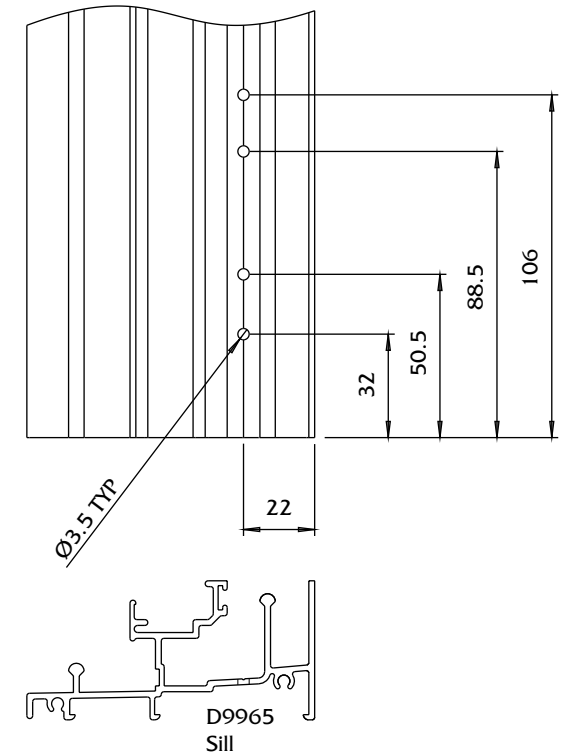

Figure B



AUSTRAL  
LOCK

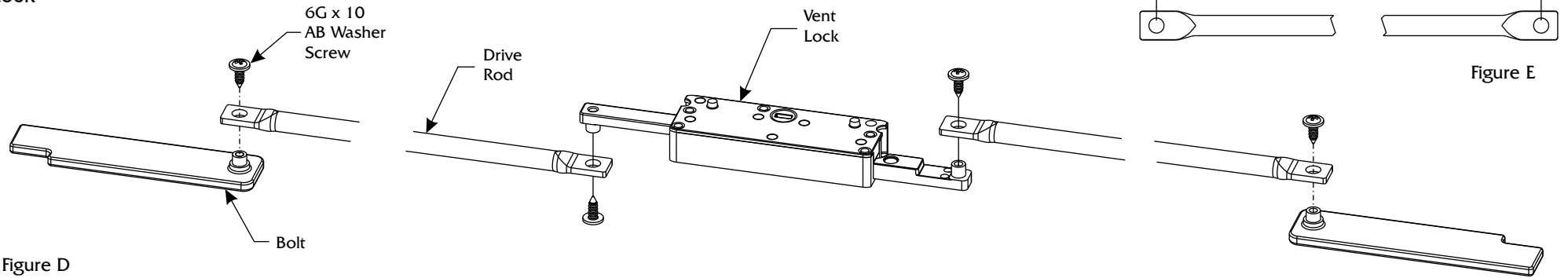

Figure D

D6832  
Lock Stile

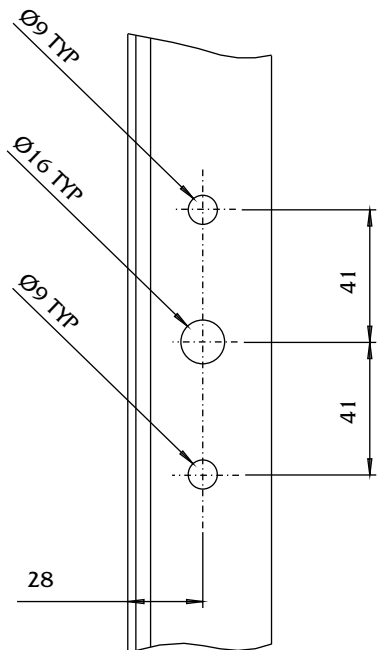
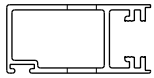

Figure C

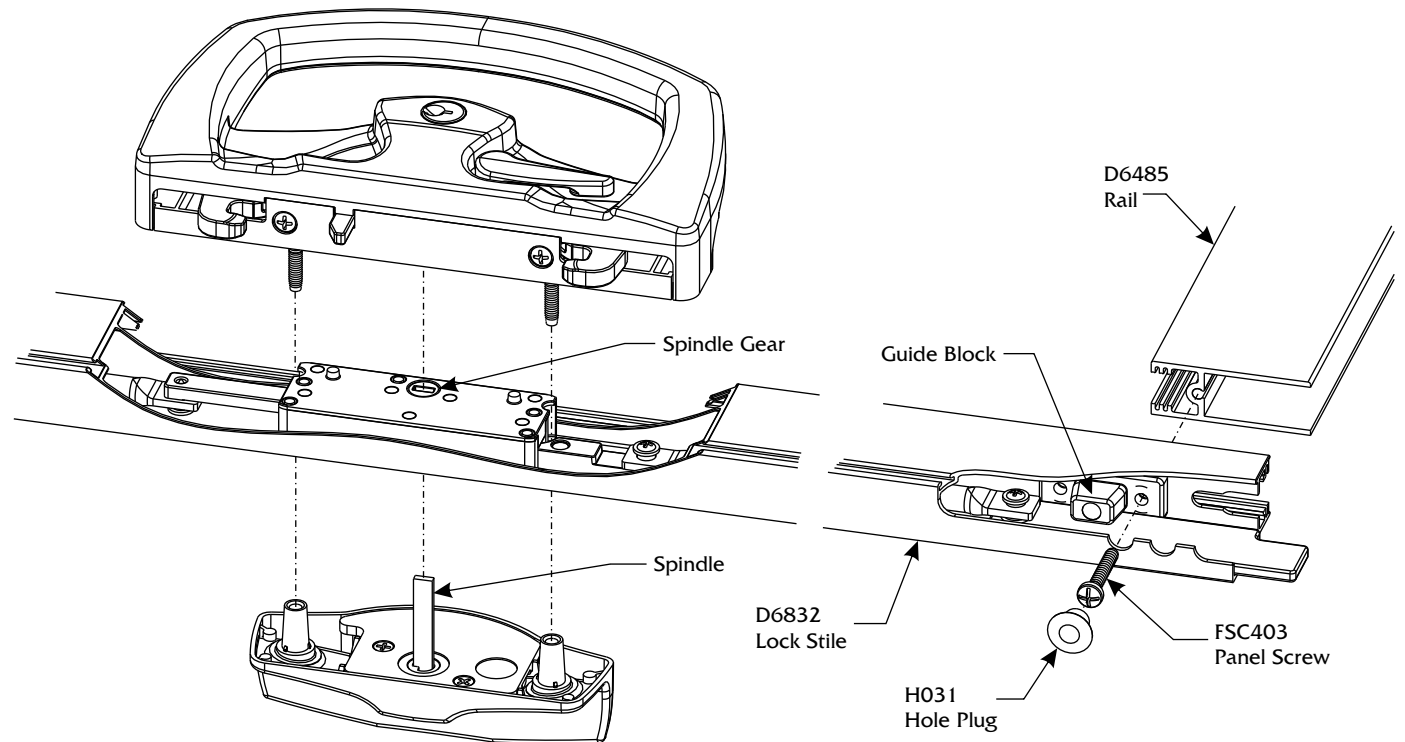

Figure F